

# HILTON ORLANDO ORANGE BALLROOM

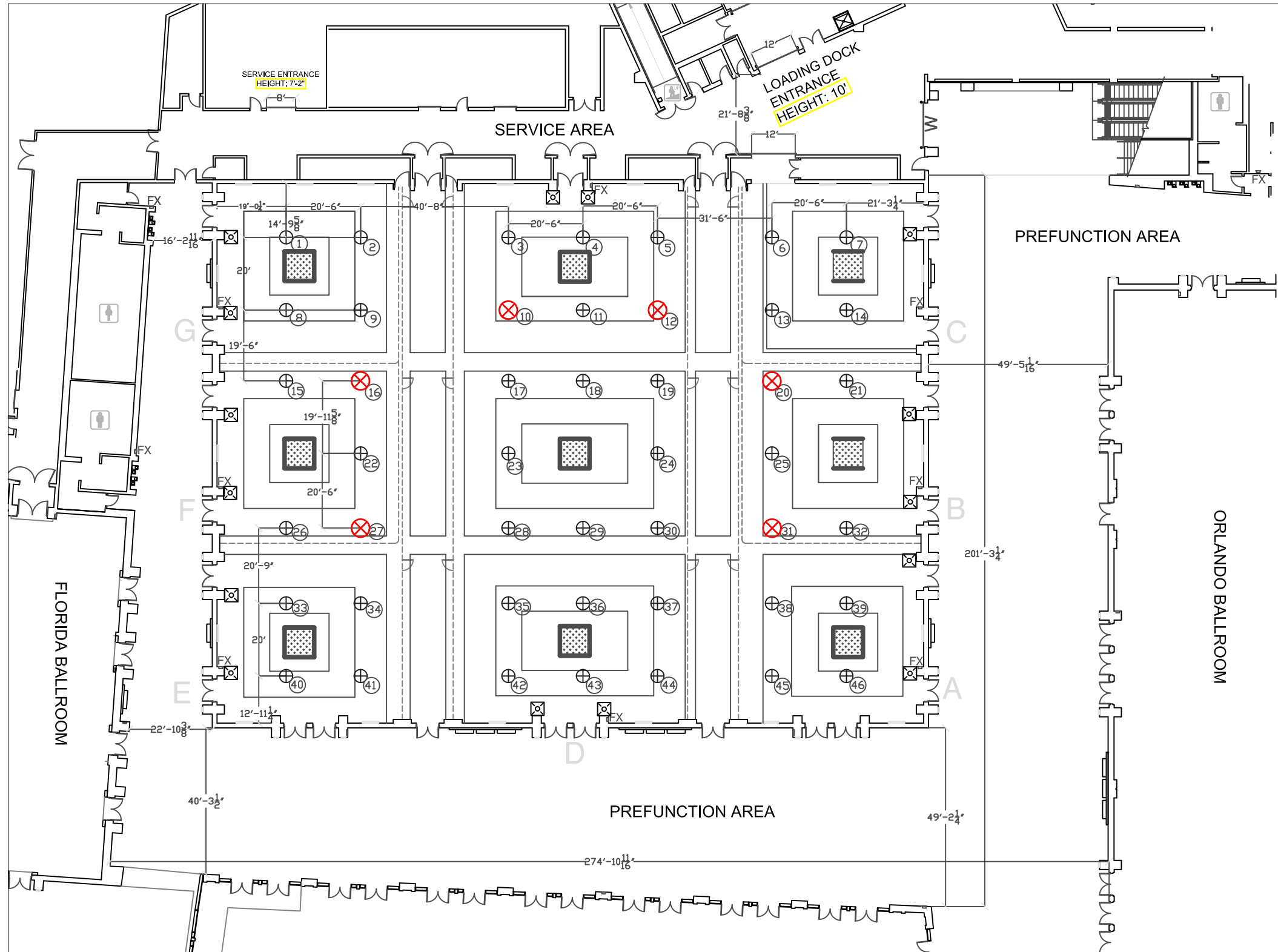

**LEGEND**

FIRE EXTINGUISHER	FX
AIRWALL	-----
CHANDELIER	■
FIRE ALARM STROBE	⊠
SKY HOOK POINTS (RIG POINT LABEL SHOWN)	⊗ ①
CEILING RIG POINTS (MAX LOAD: 1000 LBS PER POINT) (TOTAL OF 6000 LBS MAX LOAD PER TRUSS) (RIG POINT LABEL SHOWN)	⊕ ①

**HILTON ORANGE BALLROOM DIMENSIONS**

OVERALL DIMENSIONS:	195'-0" X 148'-0"
BALLROOM A OR E :	51'-0" X 49'-0"
BALLROOM B, C OR F:	49'-0" X 49'-0"
BALLROOM D:	148'-0" X 64'-0"
BALLROOM G:	50'-0" X 49'-0"

**STANDARD HEIGHTS**

① AIRWALL HEIGHT:	23'-10"
② CHANDELIER HEIGHT:	23'-6"
③ BALLROOM CEILING HEIGHT:	26'-0"
④ CHANDELIER SOFFIT HEIGHT:	25'-11"
⑤ PREFUNCTION CEILING HEIGHT:	13'-2"

SCALE 1/32" = 1' ON 11 X 17 PAPER